

SHAFTS FOR LINEAR GUIDES

We offer induction hardened and precision ground guide rollers made of Cf53 material or in stainless steel X46Cr13 version in lengths according to customer's request, also with fixing holes, threaded on the ends or the external surface.

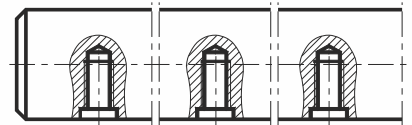

Roughness:	Ra 0,32µm
Hardness:	min. 62-64 HRC

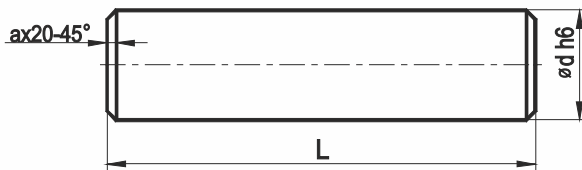

d h6	L max	a
10	6000	1
12	6000	1
13	400	1,5
14	6000	1,5
16	6000	1,5
20	6000	2
25	6000	2
30	6000	2,5
35	6000	2,5
40	6000	2,5

